

For Lease Commercial Space London, Ontario

GLEED



841 Wellington Road, London Westminster Square

- Prime location retail/office plaza
- Bright and clean 2,382 sq ft unit
- Ample parking
- Located on the corner of Wellington Road and Southdale Road with entrances on Wellington, Southdale and Montgomery
- Located next to a full-service hotel
- In the heart of south London's busiest commercial corridor

Lease Rate:
\$30.00 per sq ft net
Additional rent:
\$15.50 per sq ft

RICHARD GLEED
Broker of Record/President
rick@gleedcommercial.com
519.518.8080

MEGAN GLEED
Sales Representative
megan@gleedcommercial.com
519.518.8080

For Lease 841 Wellington Rd. S. London, Ontario

GLEED

Property Features

- Plaza is currently being redeveloped
- Broad zoning allows retail, office, including medical/dental, personal service establishments and more
- Ample parking on all sides of property

The Opportunity

- 841 Wellington Road is located on London's primary arterial road, at the Wellington Road and Southdale Road intersection
- Excellent mix of national and local tenants servicing retail, hospitality, personal services, etc.
- Unit has many windows for natural light

Neighbouring Tenants include:

- Qdoba Restaurant, Money Mart, Spartan Nutrition, Libro, and more

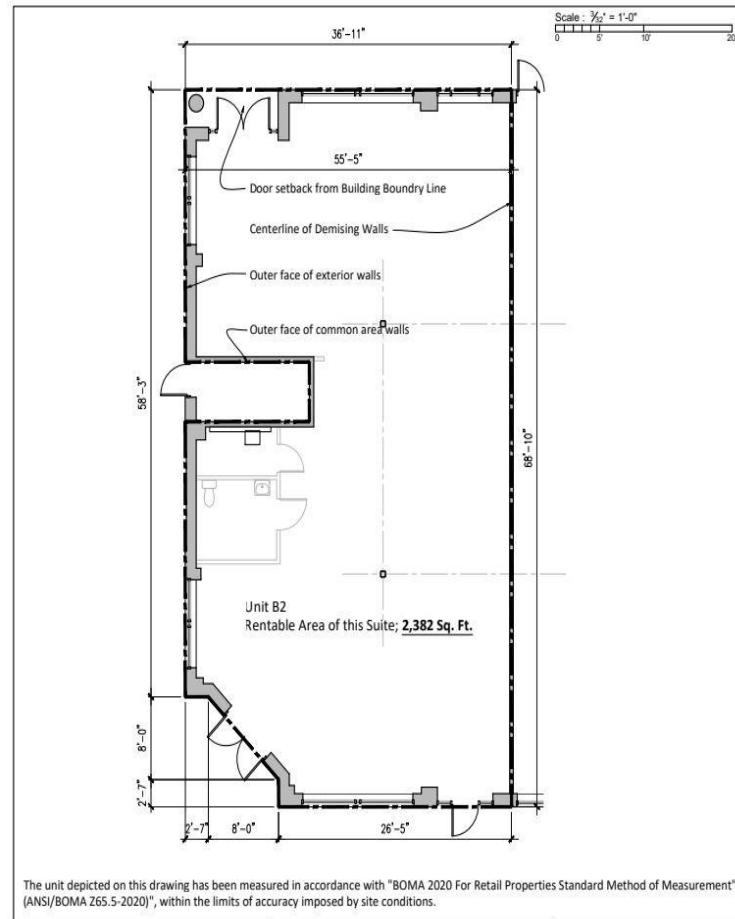

GLEED Inc., Real Estate Brokerage
89 Wharncliffe Road South
London, Ontario N6J 2K2

T 519 518 8080
F 519 518 8081